

COMUNE DI CASTENASO  
PROVINCIA DI BOLOGNA



COMPARTO VILLANOVA  
ANS C2.4

PROPRIETA'

PROGETTO	ABACO TIPOLOGICO	1:200
LOTTO: SF15	piante	
	prospetti	
	sezioni	



A	1	a
B	2	b
C	3	c
D	4	d
E	5	e
F	6	f
G	7	g
H	8	h
I	9	i
L	10	l
M	11	m
N	12	n
O	13	o
P	14	p
Q	15	q
R	16	r
S	17	s
T	18	t
U	19	u
V	20	v
Z	21	z

TECNICI		
 3BA STUDIO GIANLUCA BRINI ARCHITETTO	<b>STUDIO GBA</b> Arch. Gianluca Brini Arch. Luca Pedrazzi	
 Ing. GIAN FRANCO GIOVANNINI Studio INGEGNERIA ARCHITETTURA URBANISTICA	<b>STUDIO GIOVANNINI</b> Ing. Gian Franco Giovannini Ing. Roberto Tranquilli	
 TEAM WORK studio di architettura e ingegneria via Roma 100 - 40137 - BOLOGNA tel. 051.2611111 - fax 051.2611112	<b>STUDIO TEAM WORK S.C.A.R.L.</b> Arch. Ing. Nicola Zanni	

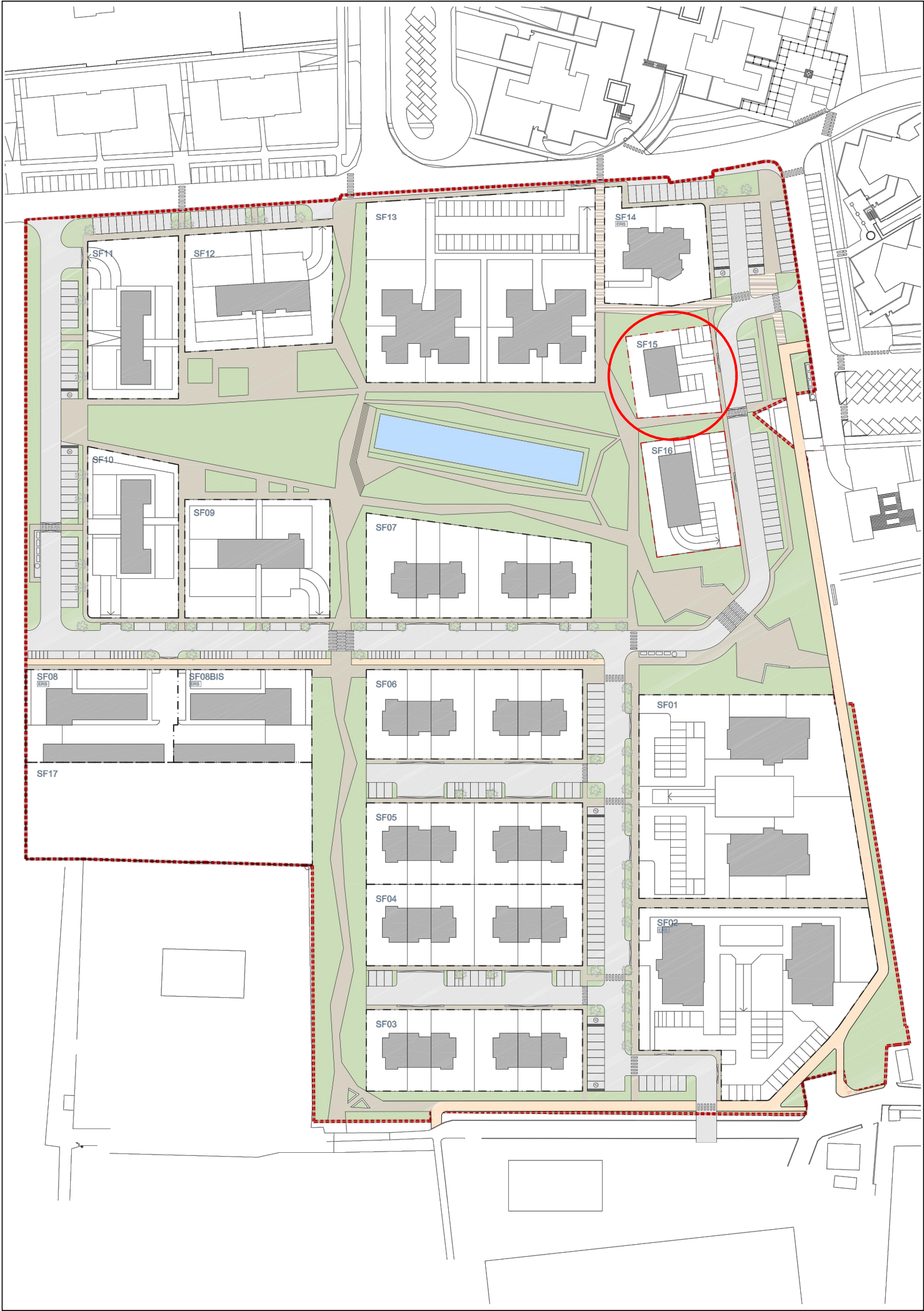

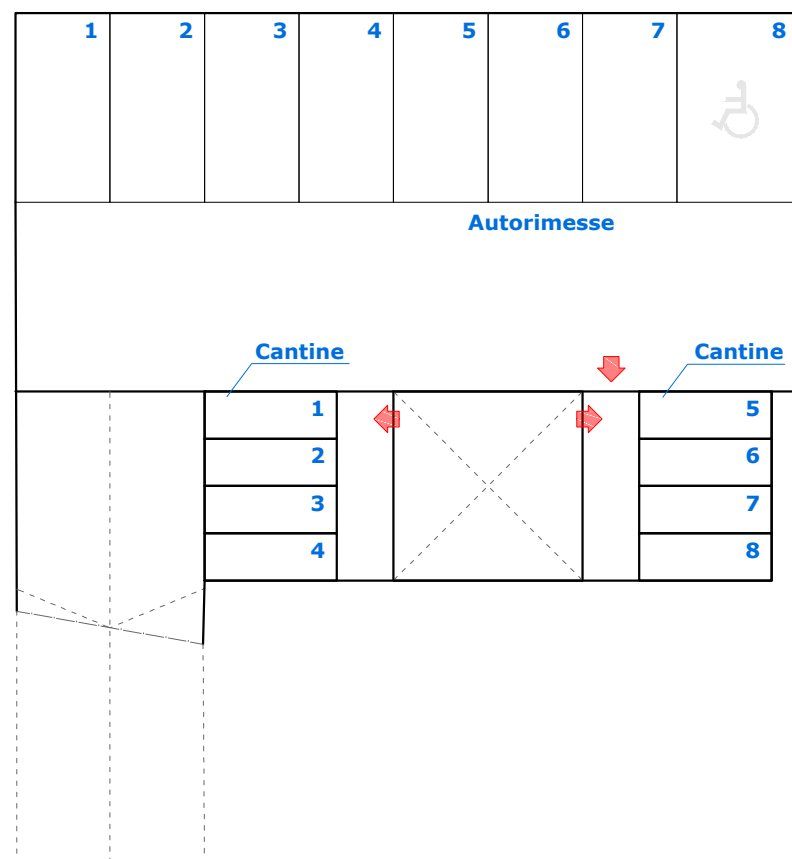
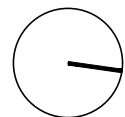

PIANO INTERRATO

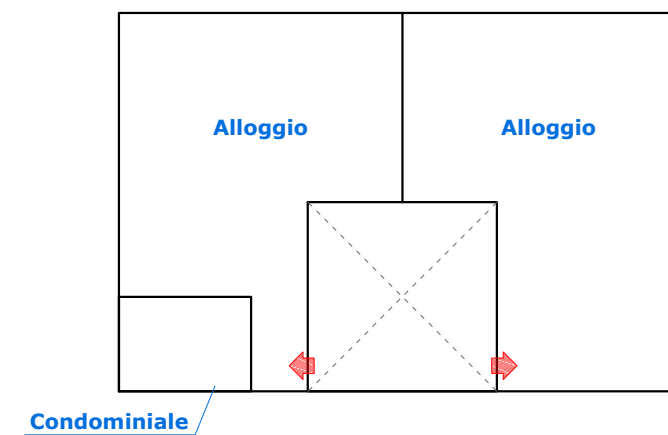
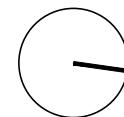

PIANO TERRA

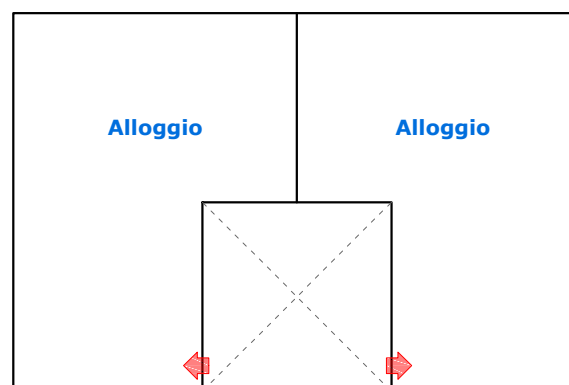
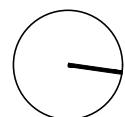

PIANO TIPO

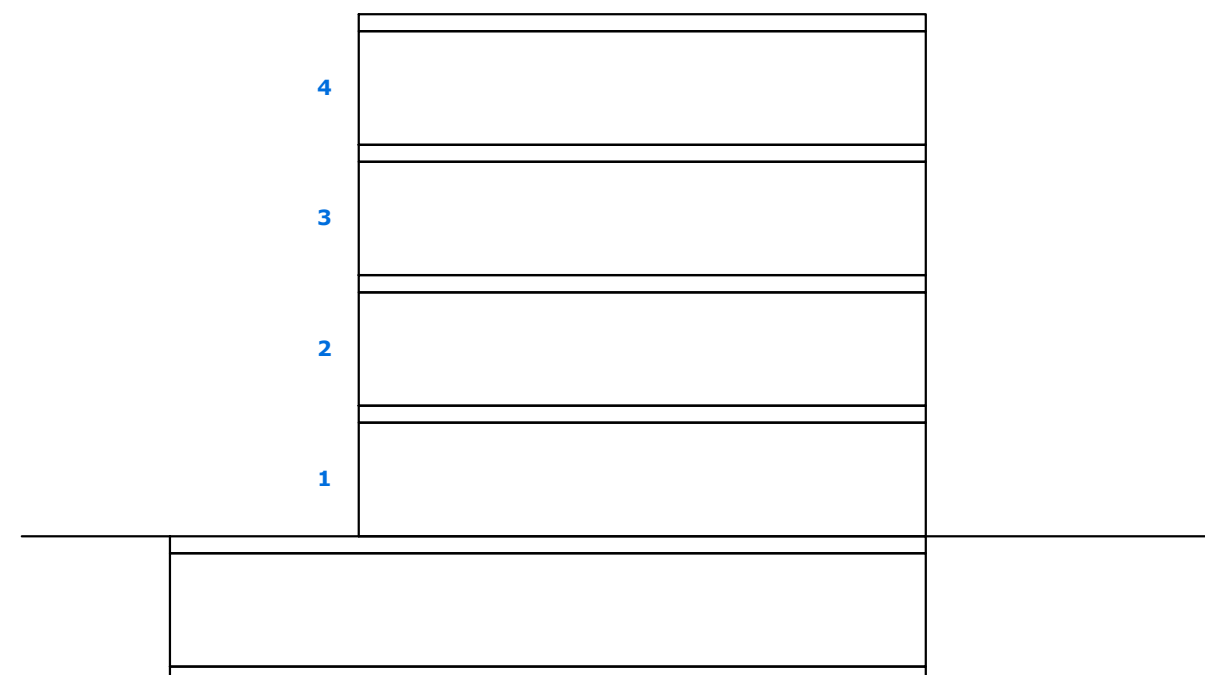

SCHEMA PROSPETTO/SEZIONE

Numero Alloggi di riferimento: 8

	GBa STUDIO		LOTTO SF15				
	PROGETTISTI: Arch. Brini Gian Luca	COLLABORATORI: Arch. Pedrazzi Luca	DATA CREAZIONE:	2017-05-08	ELABORATO:	PLANIMETRIE	H.1.b
			DATA VERIFICA:		SCALA:	1:200	
			DATA AGGIORNAMENTO:		DESCRIZIONE:	ELABORATI PUA	